

DIGITAL MONITORS MAP

MEDIUM MONITOR SPECIFICATIONS

For Student Groups or Businesses

Vertical - 1080px (W) x 1920px (H)

Horizontal - 1920px (H) x 1080 px (W)

LARGE MONITOR SPECIFICATIONS

For Student Groups or Businesses

Vertical - 1080px (W) x 1920px (H)

Horizontal - 1920px (H) x 1080 px (W)

EXTRA LARGE MONITOR SPECIFICATIONS

For Businesses

Vertical - 1080px (W) x 1920 (H)

Horizontal - 1920px (H) x 1080px (W)

RESOLUTIONS

72 DPI t

ACCEPTABLE FILE FORMATS

JPEG Image

PNG Image

Adobe Illustrator CCS Artwork (recommended)

Adobe Photoshop CCS Image (recommended unflattened)

If your advertisement is not formatted correctly, we won't run the ad, so please ensure that you follow the design guidelines!

For a complete list of our monitor guidelines, visit our website: creativelab.berkeley.edu

SUBMISSION DETAILS:

Email files to creativelab@berkeley.edu

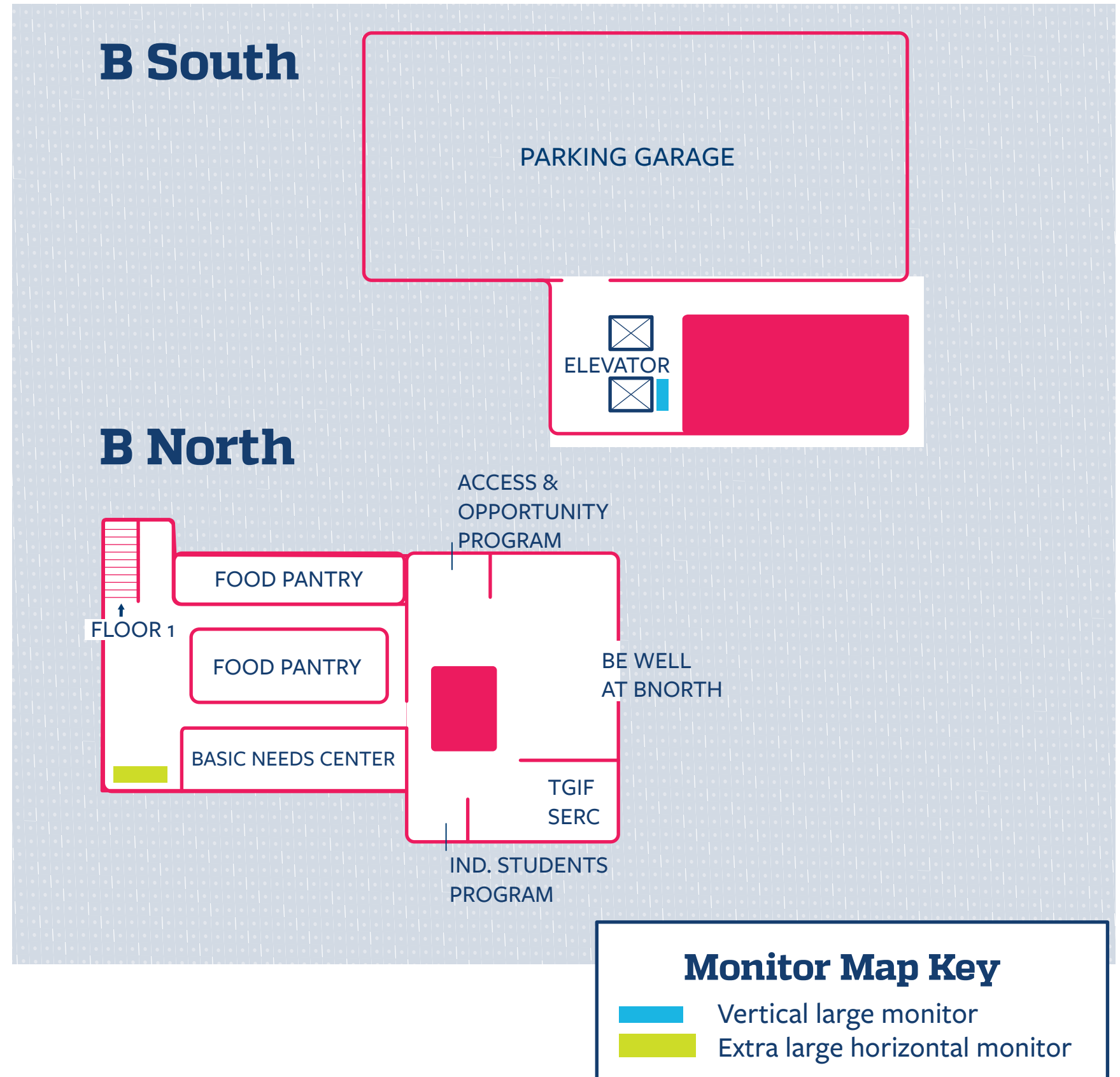

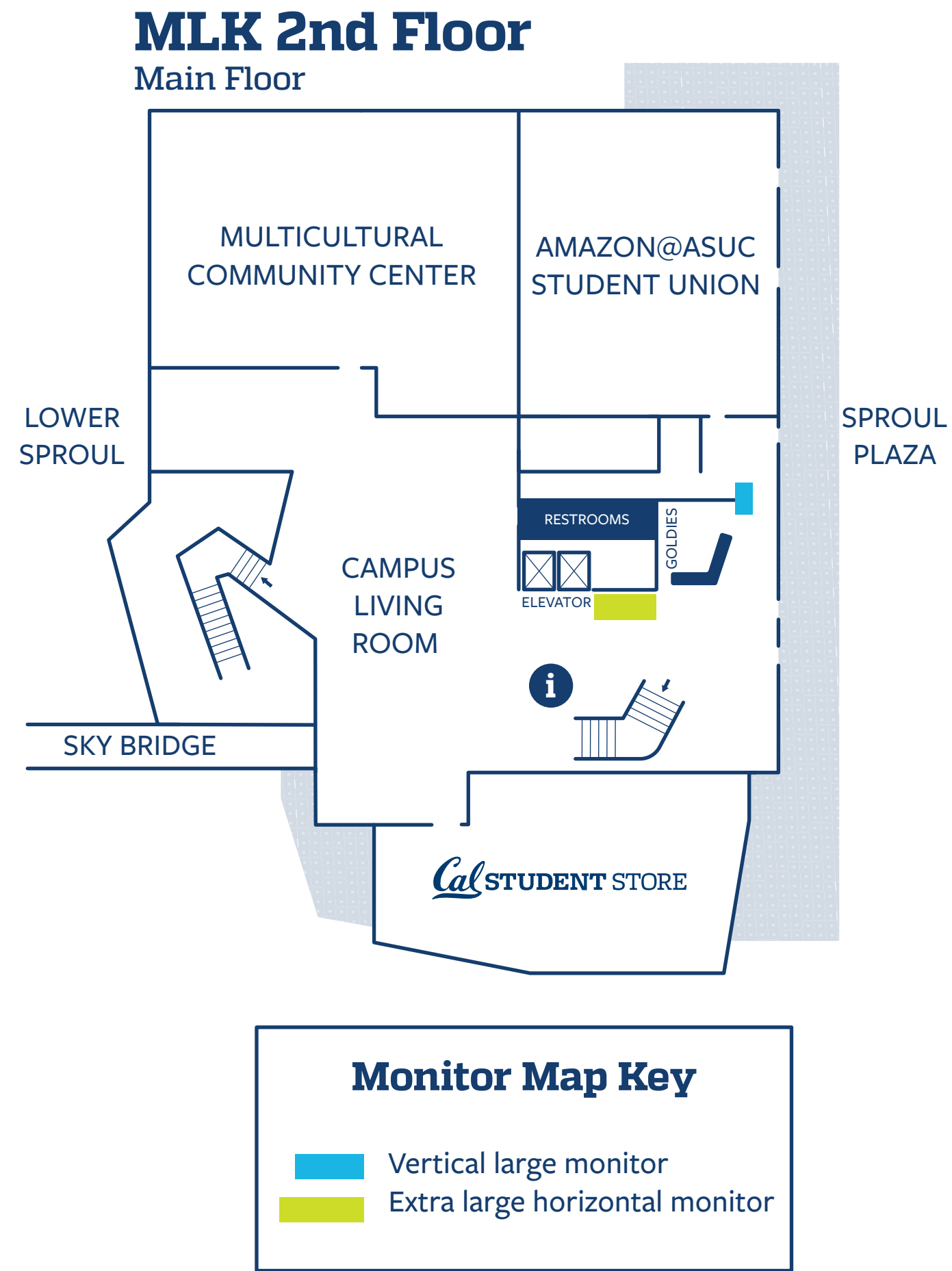

Monitor Map Key

- Vertical large monitor
- Extra large horizontal monitor

MLK 4th Floor

MLK 5th Floor

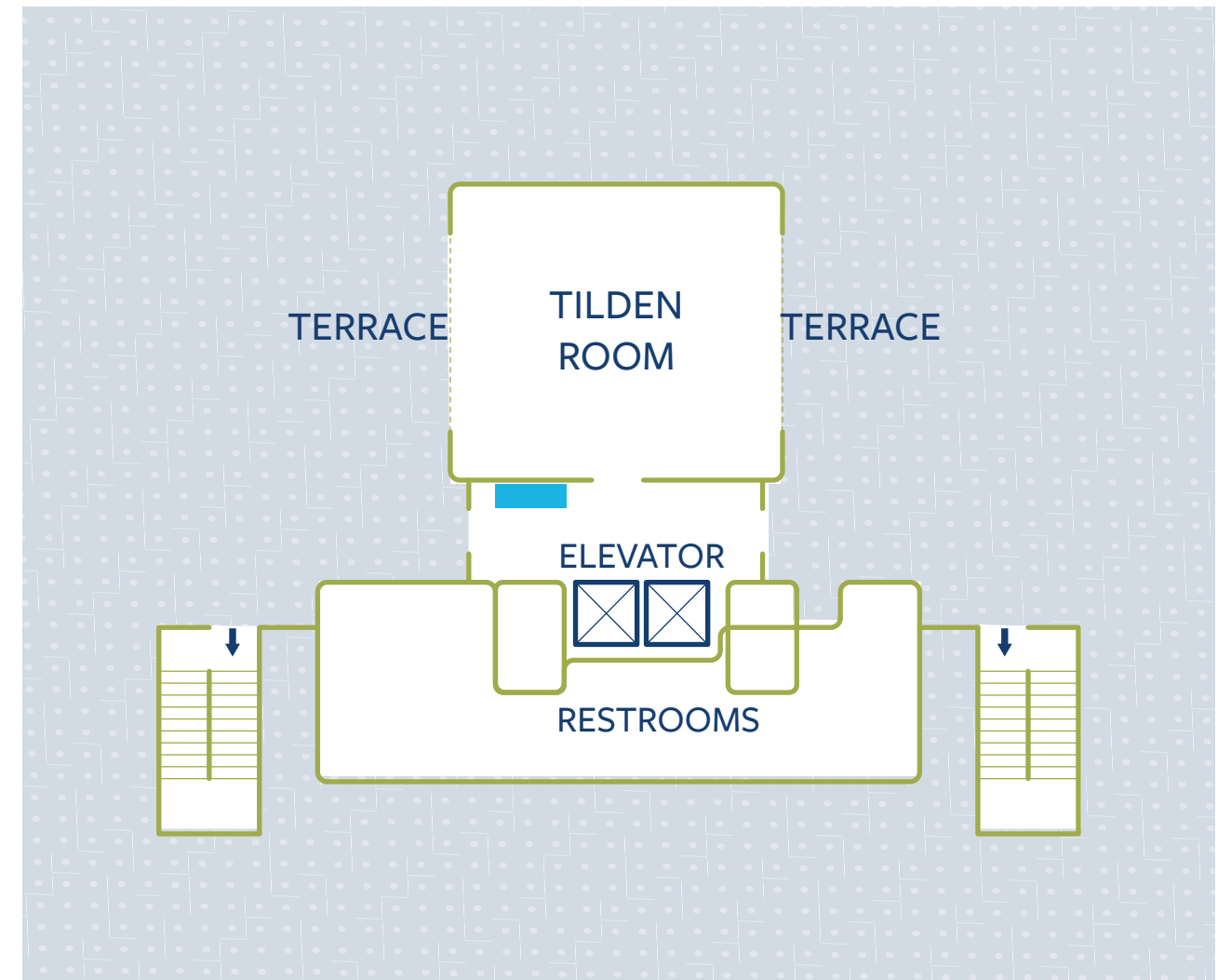
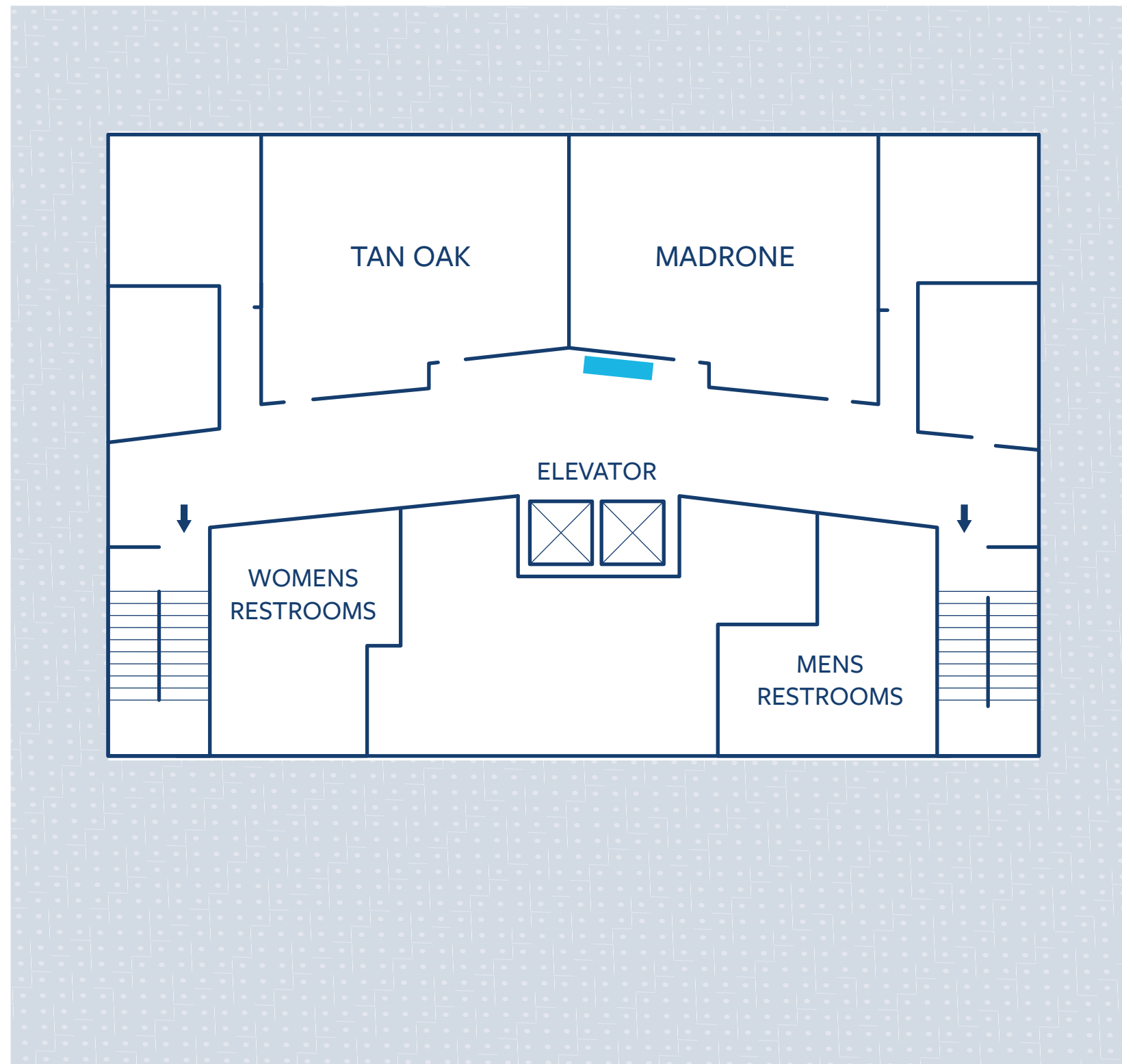

Monitor Map Key

 Vertical large monitor

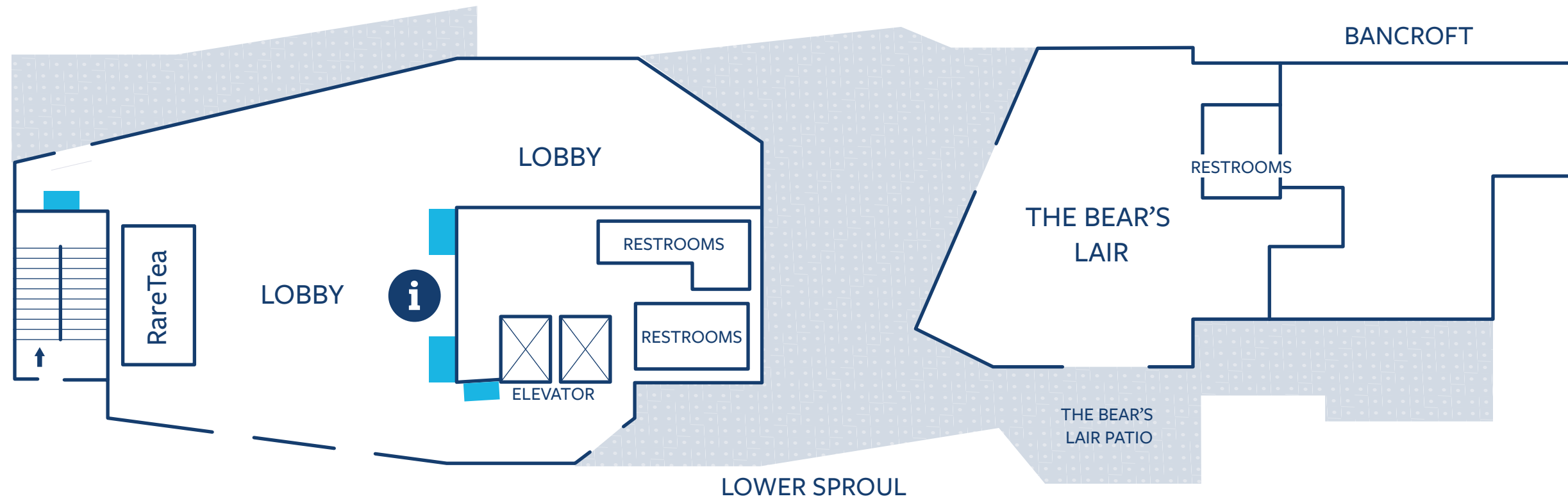

Eshleman 1st Floor
Main Floor

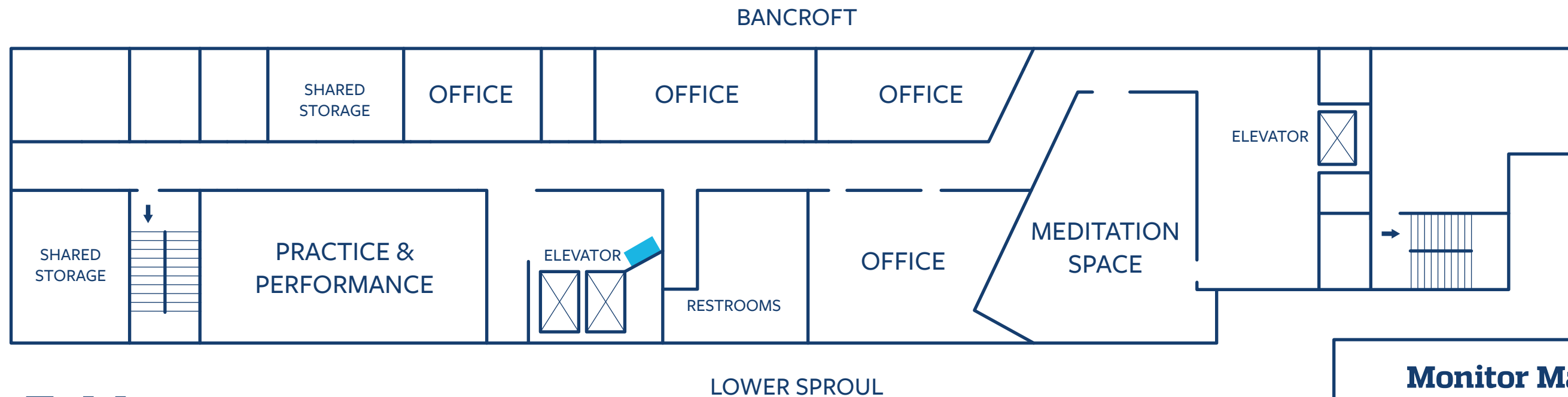

**Eshleman
Basement**

Monitor Map Key

Vertical large monitor

Eshleman 2nd Floor

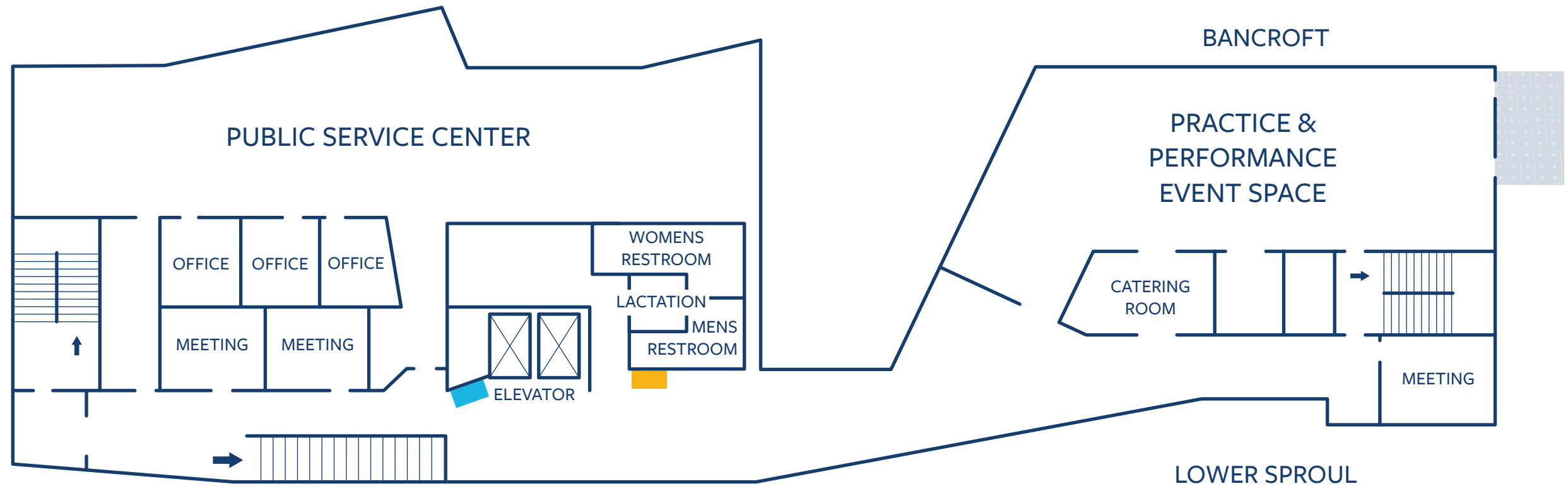

BANCROFT

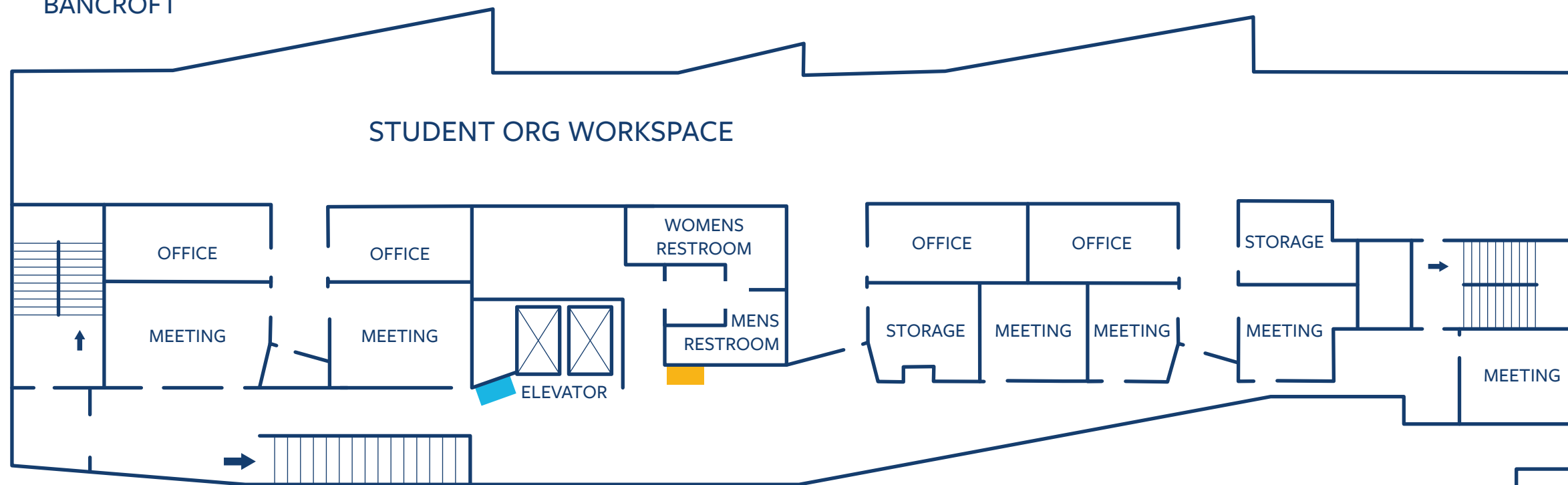

Eshleman 3rd Floor

LOWER SPROUL

Monitor Map Key

- Vertical medium monitor
- Vertical large monitor

Eshleman 4th Floor

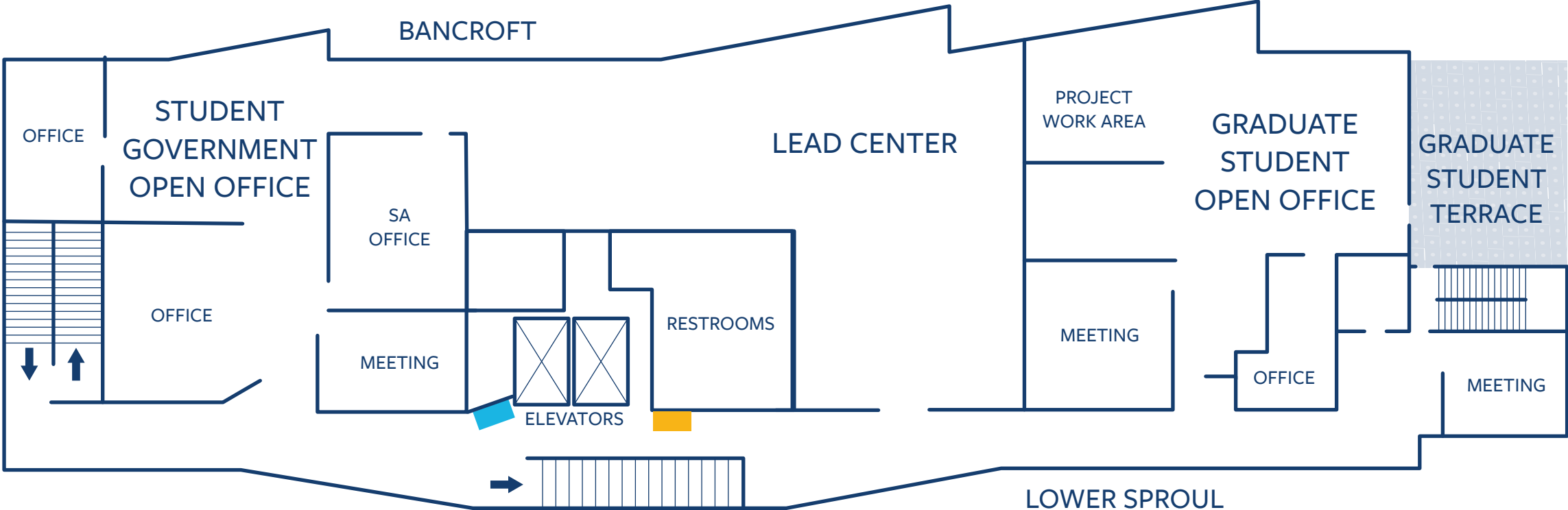

Eshleman 5th Floor

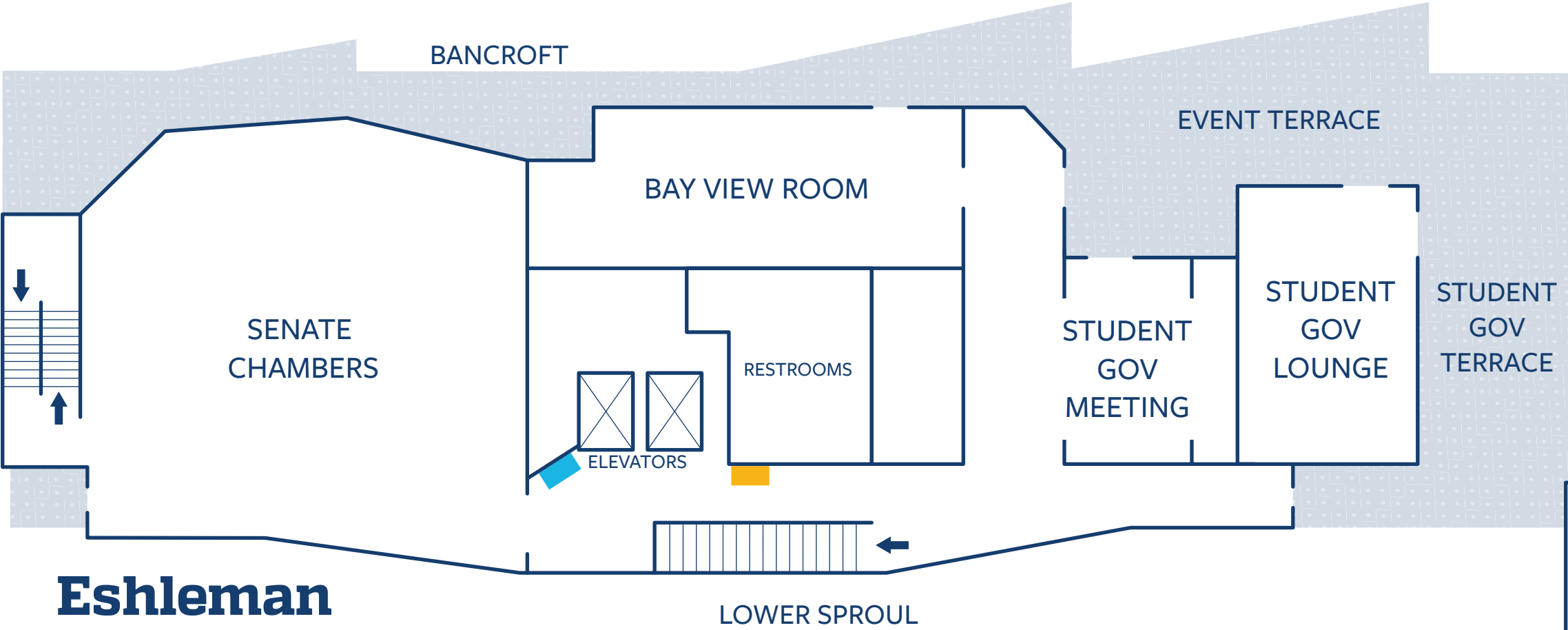

Monitor Map Key

- Vertical medium monitor
- Vertical large monitor